

Braided Hose Couplings

Direct replacement for
Parker HY Fittings.



- Direct replacement for Parker HY Fitting
- Kurt's first design
- Compatible with many crimpers
- Can be used on 1 & 2 wire braided hose
- Can be used on thermoplastic hose
- Great for industrial hose



British Flat Face Seat Female Swivel

Part Number	Hose I.D. (in.) A	B	C	D	E	Thread
F-BFPX-06-06	3/8	2.81	1.31	3/4	7/8	3/8 - 19
F-BFPX-06-08	3/8	2.92	1.42	3/4	1	1/2 - 14
F-BFPX-08-08	1/2	3.00	1.49	7/8	1	1/2 - 14
F-BFPX-08-12	1/2	2.87	1.37	1-1/4	1-1/4	3/4 - 14

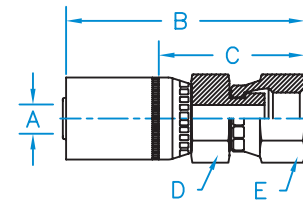

British Standard Pipe 60° Cone 45° Bent Tube Female Swivel

Part Number	Hose I.D. (in.) A	B	C	D	E	F	Thread
F-BSPX45-04-04	1/4	3.45	2.19	3/4	0.75	3/4	1/4 - 19
F-BSPX45-04-06	1/4	3.73	2.48	5/8	0.95	3/4	3/8 - 19
F-BSPX45-06-06	3/8	3.99	2.49	3/4	0.95	7/8	3/8 - 19
F-BSPX45-06-08	3/8	4.31	2.81	3/4	1.00	1	1/2 - 14
F-BSPX45-08-08	1/2	4.38	2.88	7/8	1.00	1	1/2 - 14
F-BSPX45-10-10	5/8	4.21	2.71	1-1/8	1.10	1-1/8	5/8 - 14
F-BSPX45-12-12	3/4	4.23	2.63	1-1/8	1.18	1-1/4	3/4 - 14
F-BSPX45-16-16	1	5.03	3.29	1-3/8	1.33	1-1/2	1 - 11

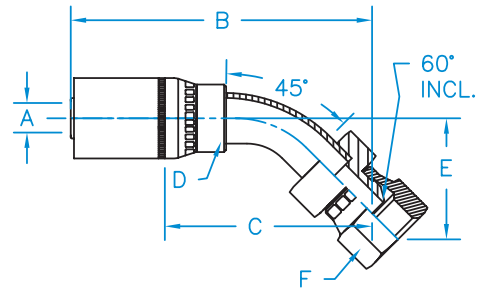

British Standard Pipe 60° Cone 90° Bent Tube Female Swivel

Part Number	Hose I.D. (in.) A	B	C	D	E	F	Thread
F-BSPX90-03-04	3/16	2.78	1.72	9/16	1.33	3/4	1/4 - 19
F-BSPX90-04-04	1/4	2.37	1.72	5/8	1.33	3/4	1/4 - 19
F-BSPX90-04-06	1/4	3.12	1.87	5/8	1.79	7/8	3/8 - 19
F-BSPX90-06-06	3/8	3.38	1.88	3/4	1.79	7/8	3/8 - 19
F-BSPX90-06-08	3/8	3.68	2.18	3/4 R	1.95	1	1/2 - 14
F-BSPX90-08-08	1/2	2.10	2.25	7/8	1.95	1	1/2 - 14
F-BSPX90-10-10	5/8	3.32	1.55	1-1/8	2.10	1-1/8	5/8 - 14
F-BSPX90-10-12	5/8	3.76	2.26	1-1/8	2.31	1-1/4	3/4 - 14
F-BSPX90-12-12	3/4	3.85	2.26	1-1/8	2.31	1-1/4	3/4 - 14
F-BSPX90-16-16	1	4.59	2.82	1-3/8	2.90	1-1/2	1 - 11

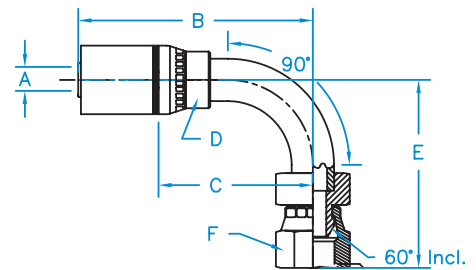

British Standard Pipe 60° Cone Female Swivel

Part Number	Hose I.D. (in.) A	B	C	D	E	Thread
F-BSPX-03-04	3/16	2.17	1.11	5/8	3/4	1/4 - 19
F-BSPX-04-02	1/4	2.30	1.04	9/16	9/16	1/8 - 28
F-BSPX-04-04	1/4	2.35	1.10	9/16	3/4	1/4 - 19
F-BSPX-04-06	1/4	2.53	1.28	11/16	7/8	3/8 - 19
F-BSPX-06-04	3/8	2.58	1.25	3/4	3/4	1/4 - 19
F-BSPX-06-06	3/8	2.80	1.30	11/16	7/8	3/8 - 19
F-BSPX-06-08	3/8	2.92	1.42	7/8	1	1/2 - 14
F-BSPX-08-06	1/2	2.90	1.40	7/8	7/8	3/8 - 19
F-BSPX-08-08	1/2	2.99	1.49	1.00	1	1/2 - 14
F-BSPX-08-10	1/2	2.85	1.34	7/8	1-1/8	5/8 - 14
F-BSPX-10-08	5/8	3.12	1.62	1-1/16	1	1/2 - 14
F-BSPX-10-10	5/8	3.22	1.72	1-1/8	1-1/8	5/8 - 14
F-BSPX-10-12	5/8	3.33	1.83	1-1/16	1-1/4	3/4 - 14
F-BSPX-12-12	3/4	3.39	1.70	1-1/8	1-1/4	3/4 - 14
F-BSPX-12-16	3/4	3.37	1.78	1-1/4	1-1/2	1 - 11
F-BSPX-16-16	1	3.51	1.78	1-3/8	1-1/2	1 - 11
F-BSPX-20-20	1-1/4	4.02	2.02	1-3/4	2	1-1/4 - 11

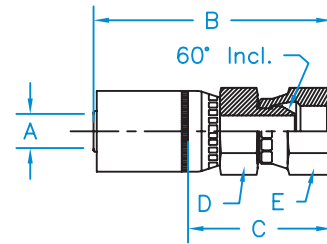

British Std Pipe 60° Cone 90° Block Style Female Swivel

Part Number	Hose I.D. (in.) A	B	C	D	E	F	Thread
F-BSPX90B-04-04	1/4	2.31	0.65	3/4	0.97	5/8	1/4 - 19
F-BSPX90B-06-06	3/8	2.77	0.74	7/8	1.13	13/16	3/8 - 19
F-BSPX90B-06-08	3/8	2.77	0.74	1	1.22	13/16	1/2 - 14
F-BSPX90B-08-08	1/2	2.91	0.88	1	1.29	15/16	1/2 - 14
F-BSPX90B-12-12	3/4	3.45	1.11	1-1/4	1.62	1-1/4	3/4 - 14
F-BSPX90B-16-16	1	4.34	2.06	1-1/2	1.45	1-5/8	1 - 11

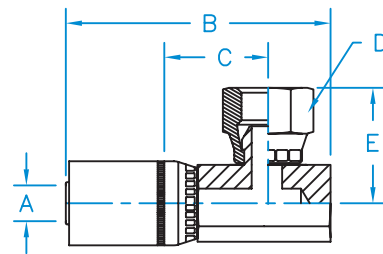

C61 - Code 61 Flange Straight Rigid

Part Number	Hose I.D. (in.) A	B	C	D	Thread
C61-08-08	1/2	3.51	1.83	7/8	N/A
C61-08-12	1/2	3.00	1.31	1-1/2	N/A
C61-12-12	3/4	3.74	2.15	1-1/8	N/A
C61-12-16	3/4	3.97	2.09	1-3/8	N/A
C61-16-16	1	4.43	1.29	1-3/8	N/A
C61-16-20	1	5.13	2.85	1-3/8	N/A
C61-20-20	1-1/4	4.02	2.02	2	N/A
C61-20-24	1-1/4	4.18	2.18	2-3/8	N/A

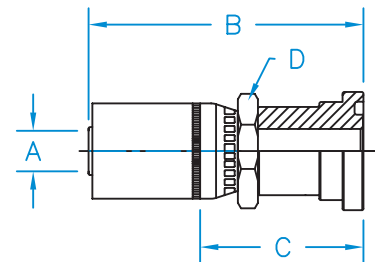

C6145 - Code 61 Flange 45° Bent Tube Rigid

Part Number	Hose I.D. (in.) A	B	C	D	E	Thread
C6145-08-08	1/2	4.07	2.57	7/8	0.75	N/A
C6145-08-12	1/2	3.84	2.34	1-1/8	0.84	N/A
C6145-12-12	3/4	4.41	2.85	1-1/8	0.84	N/A
C6145-12-16	3/4	4.32	2.72	1-3/8	1.13	N/A
C6145-12-20	3/4	4.45	2.85	1-3/8	0.94	N/A
C6145-16-16	1	4.47	2.74	1-3/8	1.13	N/A
C6145-16-20	1	4.60	2.87	1-3/8	0.94	N/A
C6145-16-24	1	4.98	3.25	1-5/8	1.03	N/A
C6145-20-20	1-1/4	5.63	3.63	1-3/4	1.26	N/A
C6145-20-24	1-1/4	5.14	3.14	1-3/4	1.03	N/A

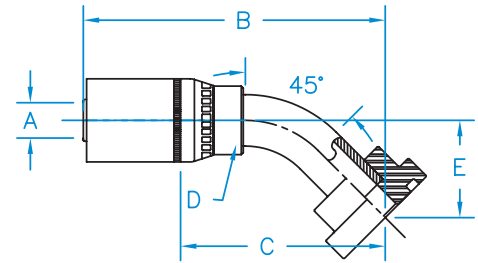

C6190 - Code 61 Flange 90° Bent Tube Rigid

Part Number	Hose I.D. (in.) A	B	C	D	E	Thread
C6190-08-08	1/2	3.40	1.90	7/8	1.63	N/A
C6190-08-12	1/2	3.75	2.25	1-1/8	1.56	N/A
C6190-12-12	3/4	4.00	2.41	1-1/8	2.31	N/A
C6190-12-16	3/4	4.31	2.71	1-3/8	2.90	N/A
C6190-12-20	3/4	4.39	2.80	1-3/8	2.25	N/A
C6190-16-16	1	4.46	2.73	1-3/8	2.90	N/A
C6190-16-20	1	5.43	3.15	1-3/8	2.37	N/A
C6190-16-24	1	6.01	3.73	1-5/8	2.74	N/A
C6190-20-20	1-1/4	5.69	3.69	1-3/4	2.68	N/A
C6190-20-24	1-1/4	5.69	3.69	1-3/4	2.74	N/A

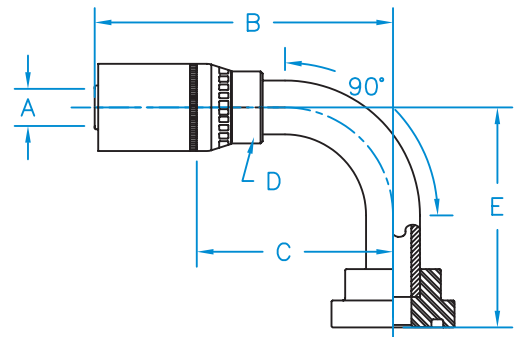

Din Heavy Universal Seat 45° Bent Tube Female Swivel

Part Number	Hose I.D. (in.) A	B	C	D	E	F	Thread
F-DINHX45-04-16	1/4	3.23	1.97	5/8	0.96	3/4	M16 X 1.5
F-DINHX45-04-18	1/4	3.26	2.00	5/8	1.11	7/8	M18 X 1.5
F-DINHX45-06-20	3/8	4.15	2.65	5/8	1.12	15/16	M20 X 1.5
F-DINHX45-06-22	3/8	3.74	2.25	3/4	1.20	1-1/16	M22 X 1.5
F-DINHX45-08-24	1/2	4.58	3.08	7/8	1.26	1-3/16	M24 X 1.5
F-DINHX45-10-30	5/8	4.35	2.85	1-1/8	1.24	1-7/16	M30 X 2.0
F-DINHX45-12-36	3/4	4.98	3.38	1-3/8	1.48	1-5/8	M36 X 2.0
F-DINHX45-16-42	1	5.55	3.27	1-3/8	1.34	1-7/8	M42 X 2.0

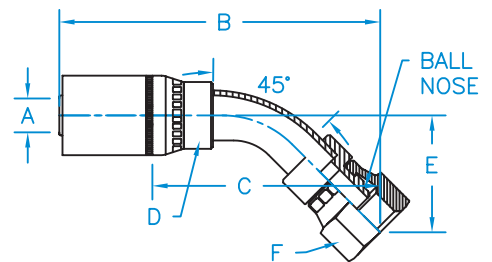

Din Heavy Universal Seat 90° Bent Tube Female Swivel

Part Number	Hose I.D. (in.) A	B	C	D	E	F	Thread
F-DINHX90-04-16	1/4	3.07	1.81	5/8	1.53	3/4	M16 X 1.5
F-DINHX90-04-18	1/4	2.44	1.19	5/8	1.86	7/8	M18 X 1.5
F-DINHX90-06-20	3/8	3.38	1.88	11/16	1.96	15/16	M20 X 1.5
F-DINHX90-06-22	3/8	3.38	1.88	3/4	1.75	1-1/16	M22 X 1.5
F-DINHX90-08-24	1/2	3.75	2.25	7/8	2.31	1-3/16	M24 X 1.5
F-DINHX90-10-30	5/8	3.73	2.23	1-1/8	2.47	1-7/16	M30 X 2.0
F-DINHX90-12-36	3/4	4.83	3.24	1-3/8	3.13	1-5/8	M36 X 2.0
F-DINHX90-16-42	1	4.08	2.37	1-3/8	2.31	1-7/8	M42 X 2.0

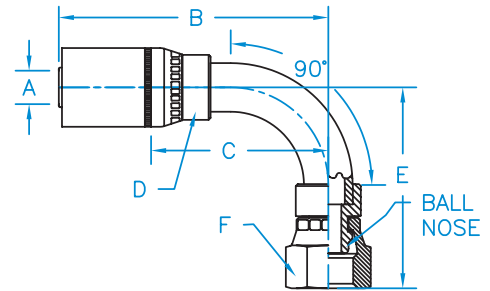

Din Heavy Universal Seat Female Swivel

Part Number	Hose I.D. (in.) A	B	C	D	E	Thread
F-DINHX-04-16	1/4	2.51	1.25	11/16	3/4	M16 X 1.5
F-DINHX-04-18	1/4	2.48	1.23	5/8	7/8	M18 X 1.5
F-DINHX-06-16	3/8	2.79	1.29	3/4	3/4	M16 X 1.5
F-DINHX-06-20	3/8	2.92	1.42	11/16	15/16	M20 X 1.5
F-DINHX-06-22	3/8	2.77	1.27	3/4	1-1/16	M22 X 1.5
F-DINHX-08-20	1/2	2.91	1.41	7/8	15/16	M20 X 1.5
F-DINHX-08-24	1/2	2.84	1.34	7/8	1-3/16	M24 X 1.5
F-DINHX-10-30	5/8	3.34	1.84	1-1/8	1-7/16	M30 X 2.0
F-DINHX-12-36	3/4	3.43	1.84	1-5/16	1-5/8	M36 X 2.0
F-DINHX-16-42	1	3.67	1.94	1-1/2	1-7/8	M42 X 2.0

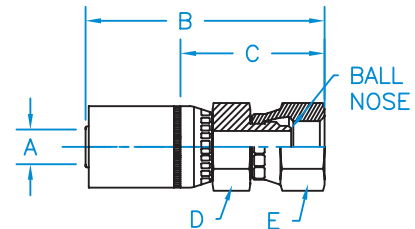

Din Heavy Universal Seat Male Rigid

Part Number	Hose I.D. (in.) A	B	C	D	Thread
M-DH04-08-16	1/4	2.38	1.12	11/16	M16 X 1.5
M-DH04-10-18	1/4	2.38	1.12	11/16	M18 X 1.5
M-DH06-10-18	3/8	2.64	1.14	3/4	M18 X 1.5
M-DH06-12-20	3/8	2.71	1.21	15/16	M20 X 1.5
M-DH06-14-22	3/8	2.73	1.23	15/16	M22 X 1.5
M-DH08-16-24	1/2	2.80	1.30	1	M24 X 1.5
M-DH10-20-30	5/8	2.89	1.39	1-3/16	M30 X 2.0
M-DH12-25-36	3/4	3.16	1.57	1-1/2	M36 X 2.0
M-DH16-30-42	1	3.40	1.66	1-11/16	M42 X 2.0

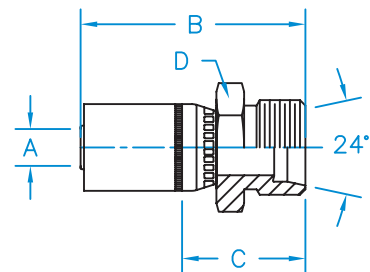

Din Light Universal Seat 45° Bent Tube Female Swivel

Part Number	Hose I.D. (in.) A	B	C	D	E	F	Thread
F-DINLX45-04-14	1/4	3.12	1.87	5/8	0.86	11/16	M14 X 1.5
F-DINLX45-04-16	1/4	3.92	2.66	5/8	1.13	3/4	M16 X 1.5
F-DINLX45-06-16	3/8	4.27	2.77	11/16	1.77	3/4	M16 X 1.5
F-DINLX45-06-18	3/8	4.17	2.67	3/4	1.13	7/8	M18 X 1.5
F-DINLX45-08-22	1/2	4.38	2.88	7/8	1.06	1-1/16	M22 X 1.5
F-DINLX45-10-26	5/8	3.99	2.49	1-1/8	1.40	1-1/4	M26 X 1.5
F-DINLX45-12-30	3/4	4.88	3.28	1-1/8	1.84	1-7/16	M30 X 2.0
F-DINLX45-16-36	1	5.16	3.42	1-3/8	1.44	1-5/8	M36 X 2.0

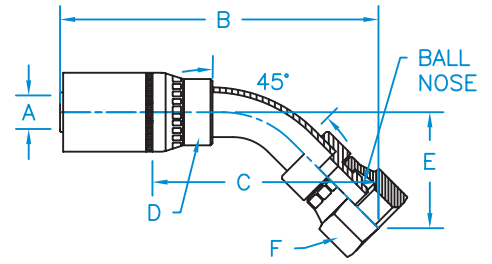

Din Light Universal Seat 90° Bent Tube Female Swivel

Part Number	Hose I.D. (in.) A	B	C	D	E	F	Thread
F-DINLX90-04-12	1/4	2.98	1.72	5/8	1.44	9/16	M12 X 1.5
F-DINLX90-04-14	1/4	2.98	1.72	5/8	1.42	11/16	M14 X 1.5
F-DINLX90-04-16	1/4	2.38	1.13	5/8	1.73	3/4	M16 X 1.5
F-DINLX90-06-16	3/8	3.38	1.88	11/16	1.99	3/4	M16 X 1.5
F-DINLX90-06-18	3/8	3.38	1.88	3/4	1.98	7/8	M18 X 1.5
F-DINLX90-08-22	1/2	3.75	2.25	7/8	2.02	1-1/16	M22 X 1.5
F-DINLX90-10-26	5/8	4.03	2.53	1-1/8	2.37	1-1/4	M26 X 1.5
F-DINLX90-12-30	3/4	3.87	2.28	1-1/8	2.82	1-7/16	M30 X 2.0
F-DINLX90-16-36	1	4.95	3.22	1-3/8	3.22	1-5/8	M36 X 2.0

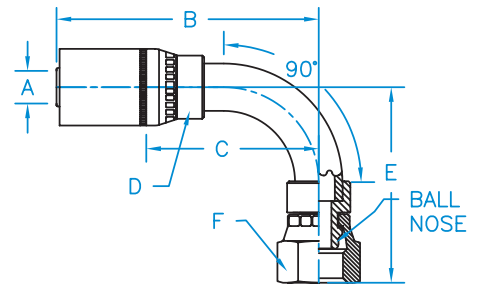

Din Light Universal Seat Female Swivel

Part Number	Hose I.D. (in.) A	B	C	D	E	Thread
F-DINLX-04-12	1/4	2.40	1.14	9/16	9/16	M12 X 1.5
F-DINLX-04-14	1/4	2.42	1.16	9/16	11/16	M14 X 1.5
F-DINLX-04-16	1/4	2.47	1.21	5/8	3/4	M16 X 1.5
F-DINLX-06-16	3/8	2.86	1.36	11/16	3/4	M16 X 1.5
F-DINLX-06-18	3/8	2.73	1.24	11/16	7/8	M18 X 1.5
F-DINLX-06-22	3/8	2.89	1.39	7/8	1-1/16	M22 X 1.5
F-DINLX-08-22	1/2	2.85	1.35	7/8	1-1/16	M22 X 1.5
F-DINLX-10-26	5/8	3.11	1.61	1-1/8	1-1/4	M26 X 1.5
F-DINLX-12-30	3/4	3.43	1.69	1-1/8	1-7/16	M30 X 2.0
F-DINLX-16-36	1	3.58	1.86	1-3/8	1-5/8	M36 X 2.0

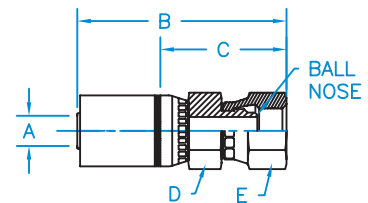

Din Light Universal Seat Male Rigid

Part Number	Hose I.D. (in.) A	B	C	D	Thread
M-DL04-06-12	1/4	2.27	1.02	9/16	M12 X 1.5
M-DL04-08-14	1/4	2.14	0.89	5/8	M14 X 1.5
M-DL04-10-16	1/4	2.34	1.08	11/16	M16 X 1.5
M-DL06-10-16	3/8	2.64	1.14	11/16	M16 X 1.5
M-DL06-12-18	3/8	2.60	1.10	11/16	M18 X 1.5
M-DL06-15-22	3/8	2.64	1.14	7/8	M22 X 1.5
M-DL08-15-22	1/2	2.72	1.22	7/8	M22 X 1.5
M-DL10-18-26	5/8	2.73	1.23	1-1/8	M26 X 1.5
M-DL12-22-30	3/4	2.90	1.31	1-3/16	M30 X 2.0
M-DL16-28-36	1	3.16	1.43	1-1/2	M36 X 2.0

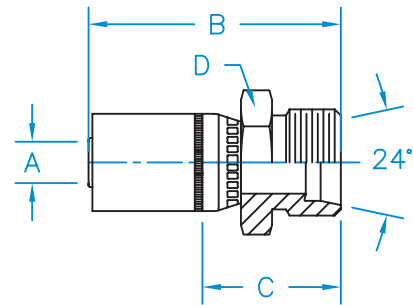

Female Grease Tap Rigid

Part Number	Hose I.D. (in.) A	B	C	D	Thread
GT-04-08	1/4	2.34	1.09	3/4	1/2 - 27
GT-06-08	3/8	2.60	1.10	3/4	1/2 - 27

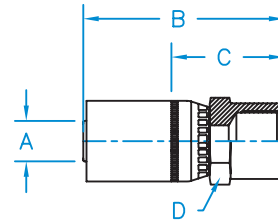

FFX - O-Ring Face Seal Female Swivel

Part Number	Hose I.D. (in.) A	B	C	D	E	Thread
FFX-04-04	1/4	2.31	1.06	9/16	11/16	9/16 - 18
FFX-04-06	1/4	2.41	1.20	11/16	13/16	11/16 - 16
FFX-06-04	3/8	2.70	1.20	3/4	11/16	9/16 - 18
FFX-06-06	3/8	2.67	1.15	11/16	13/16	11/16 - 16
FFX-06-08	3/8	2.84	0.70	7/8	15/16	13/16 - 16
FFX-08-06	1/2	2.88	1.43	7/8	13/16	11/16 - 16
FFX-08-08	1/2	2.92	1.42	7/8	15/16	13/16 - 16
FFX-08-10	1/2	3.11	1.60	15/16	1-1/8	1 - 14
FFX-08-12	1/2	3.21	1.71	1-1/8	1-3/8	1-3/16 - 12
FFX-10-08	5/8	3.04	1.54	1-1/8	1	13/16 - 16
FFX-10-10	5/8	3.13	1.63	1-1/8	1-1/8	1 - 14
FFX-10-12	5/8	3.23	1.73	1-1/8	1-3/8	1-3/16 - 12
FFX-12-10	3/4	3.21	1.62	1-1/8	1-1/8	1 - 14
FFX-12-12	3/4	3.23	1.73	1-1/8	1-3/8	1-3/16 - 12
FFX-12-16	3/4	3.38	1.78	1-1/4	1-5/8	1-7/16 - 12
FFX-16-16	1	3.61	1.90	1-1/8	1-5/8	1-7/16 - 12
FFX-16-20	1	3.60	1.87	1-5/8	1-7/8	1-11/16 - 12
FFX-20-20	1-1/4	3.87	1.87	1-3/4	1-7/8	1-11/16 - 12
FFX-20-24	1-1/4	4.21	2.21	1-7/8	2-1/4	2 - 12

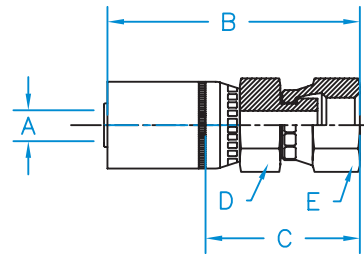

FFX45 - O-Ring Face Seal 45° Bent Tube Female Swivel

Part Number	Hose I.D. (in.) A	B	C	D	E	F	Thread
FFX45-04-04	1/4	3.14	1.88	5/8	0.39	11/16	9/16 - 18
FFX45-04-06	1/4	3.23	1.97	5/8	0.44	13/16	11/16 - 16
FFX45-06-06	3/8	3.47	1.97	3/4	0.43	13/16	11/16 - 16
FFX45-06-08	3/8	3.43	1.93	3/4	0.59	15/16	13/16 - 16
FFX45-08-06	1/2	3.58	2.08	7/8	0.43	13/16	11/16 - 16
FFX45-08-08	1/2	3.50	2.00	7/8	0.59	15/16	13/16 - 16
FFX45-08-10	1/2	3.72	2.21	7/8	0.63	1-1/8	1 - 14
FFX45-08-12	1/2	3.77	2.27	1-1/8	0.83	1-3/8	1-3/16 - 12
FFX45-10-10	5/8	3.74	2.24	1-1/16	0.63	1-1/8	1 - 14
FFX45-10-12	5/8	3.78	2.28	1-1/8	.83	1-3/8	1-3/16 - 12
FFX45-12-10	3/4	3.95	2.36	1-1/8	0.63	1-1/8	1 - 14
FFX45-12-12	3/4	3.87	2.28	1-1/8	0.83	1-3/8	1-3/16 - 12
FFX45-12-16	3/4	4.54	2.95	1-1/8	0.97	1-5/8	1-7/16 - 12
FFX45-16-16	1	4.55	2.82	1-3/8	0.95	1-5/8	1-7/16 - 12
FFX45-16-20	1	5.04	3.31	1-3/8	1.30	1-7/8	1-11/16 - 12
FFX45-20-20	1-1/4	5.71	3.71	1-3/4	1.33	1-7/8	1-11/16 - 12

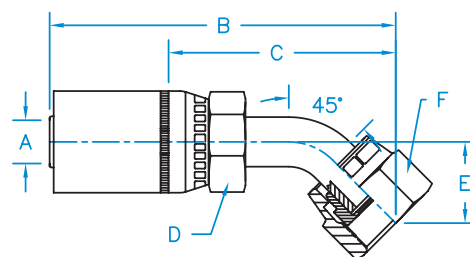

FFX90 - O-Ring Face Seal 90° Bent Tube Female Swivel

Part Number	Hose I.D. (in.) A	B	C	D	E	F	Thread
FFX90-04-04	1/4	2.98	1.72	5/8	0.82	11/16	9/16 - 18
FFX90-04-06	1/4	3.12	1.87	5/8	0.91	13/16	11/16 - 16
FFX90-06-04	3/8	3.24	1.74	11/16	0.82	11/16	9/16 - 18
FFX90-06-06	3/8	3.38	1.88	11/16	0.91	13/16	11/16 - 16
FFX90-06-08	3/8	3.34	1.84	3/4	1.14	15/16	13/16 - 16
FFX90-08-06	1/2	3.46	1.96	7/8	0.91	13/16	11/16 - 16
FFX90-08-08	1/2	3.31	1.81	7/8	1.14	15/16	13/16 - 16
FFX90-08-10	1/2	3.71	2.21	7/8	1.26	1-1/8	1 - 14
FFX90-08-12	1/2	3.78	2.28	1-1/8	1.98	1-3/8	1-3/16 - 12
FFX90-10-08	5/8	3.43	1.93	1-1/8	1.14	15/16	13/16 - 16
FFX90-10-10	5/8	3.73	2.23	1-1/16	1.26	1-1/8	1 - 14
FFX90-10-12	5/8	3.80	2.30	1-1/8	1.88	1-3/8	1-3/16 - 12
FFX90-12-10	3/4	3.94	2.35	1-1/8	1.26	1-1/8	1 - 14
FFX90-12-12	3/4	3.89	2.30	1-1/8	1.88	1-3/8	1-3/16 - 12
FFX90-12-16	3/4	4.28	2.68	1-3/8	2.20	1-5/8	1-7/16 - 12
FFX90-16-16	1	4.43	2.71	1-3/8	2.21	1-5/8	1-7/16 - 12
FFX90-16-20	1	5.32	3.58	1-5/8	2.51	1-7/8	1-11/16 - 12
FFX90-20-20	1-1/4	5.44	3.44	1-3/4	3.10	1-7/8	1-11/16 - 12

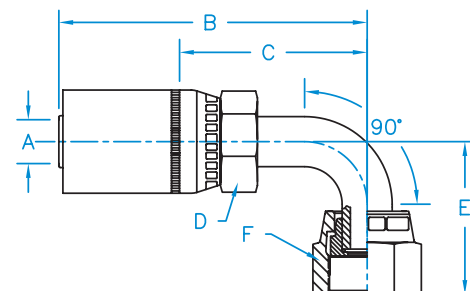

FFX90L - O-Ring Face Seal 90° Long Drop Female Swivel

Part Number	Hose I.D. (in.) A	B	C	D	E	F	Thread
FFX90L-04-04	1/4	2.98	1.72	5/8	1.81	11/16	9/16 - 18
FFX90L-06-06	3/8	3.38	1.88	3/4	2.13	13/16	11/16 - 16
FFX90L-06-08	3/8	3.68	2.18	3/4	2.52	15/16	13/16 - 16
FFX90L-08-08	1/2	3.75	2.25	7/8	2.52	15/16	13/16 - 16
FFX90L-08-10	1/2	3.71	2.21	7/8	2.76	1-1/8	1 - 14
FFX90L-10-10	5/8	3.73	2.23	1-1/8	2.77	1-1/8	1 - 14
FFX90L-10-12	5/8	3.72	2.22	1-1/8	3.83	1-3/8	1-3/16 - 12
FFX90L-12-12	3/4	3.89	2.30	1-1/8	3.92	1-3/8	1-3/16 - 12
FFX90L-16-16	1	4.44	2.71	1-3/8	4.48	1-5/8	1-7/16 - 12

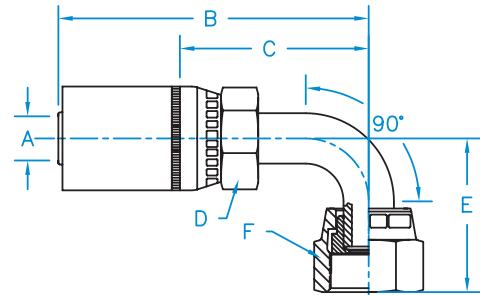

FFX90M - O-Ring Face Seal 90° Medium Drop Bent Tube Female Swivel

Part Number	Hose I.D. (in.) A	B	C	D	E	F	Thread
FFX90M-04-04	1/4	2.32	1.07	5/8	1.26	11/16	9/16 - 18
FFX90M-06-06	3/8	3.38	1.88	11/16	1.53	13/16	11/16 - 16
FFX90M-06-08	3/8	3.24	1.74	3/4	1.61	15/16	13/16 - 16
FFX90M-08-06	1/2	3.46	1.96	7/8	1.53	13/16	11/16 - 16
FFX90M-08-08	1/2	3.31	1.81	7/8	1.61	15/16	13/16 - 16
FFX90M-10-10	5/8	3.05	1.55	1-1/16	1.85	1-1/8	1 - 14
FFX90M-12-12	3/4	3.89	2.30	1-1/8	2.28	1-3/8	1-3/16 - 12
FFX90M-16-16	1	4.24	2.51	1-3/8	2.64	1-5/8	1-7/16 - 12

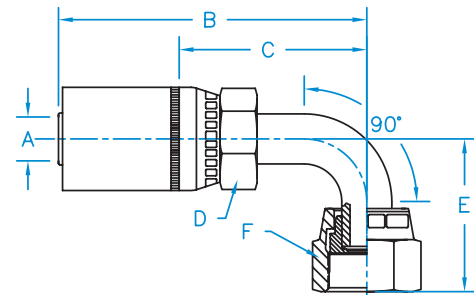

FFXT - O-Ring Face Seal Female Swivel Long

Part Number	Hose I.D. (in.) A	B	C	D	E	Thread
FFXT-04-04	1/4	2.57	1.31	9/16	11/16	9/16 - 18
FFXT-04-06	1/4	2.54	1.28	11/16	13/16	11/16 - 16
FFXT-06-04	3/8	2.87	1.37	11/16	11/16	9/16 - 18
FFXT-06-06	3/8	2.80	1.30	11/16	13/16	11/16 - 16
FFXT-06-08	3/8	2.94	1.44	3/4	15/16	13/16 - 16
FFXT-08-08	1/2	3.03	1.53	7/8	15/16	13/16 - 16
FFXT-08-12	1/2	3.21	1.71	1-1/8	1-3/8	1-3/16 - 12
FFXT-10-10	5/8	3.11	1.61	1-1/8	1-1/8	1 - 14
FFXT-10-12	5/8	3.22	1.72	1-1/8	1-3/8	1-3/16 - 12
FFXT-12-12	3/4	3.66	2.07	1-1/8	1-3/8	1-3/16 - 12
FFXT-16-16	1	3.65	1.92	1-3/8	1-5/8	1-7/16 - 12

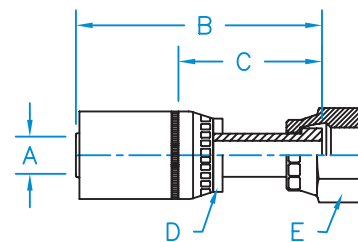

FJX - 37° JIC Female Swivel

Part Number	Hose I.D. (in.) A	B	C	D	E	Thread
FJX-02-03	1/8	1.65	1.05	1/2	9/16	3/8 - 24
FJX-02-04	1/8	1.72	1.10	1/2	9/16	7/16 - 20
FJX-03-04	3/16	2.19	1.13	9/16	9/16	7/16 - 20
FJX-03-05	3/16	2.19	1.13	9/16	5/8	1/2 - 20
FJX-04-03	1/4	2.44	1.19	5/8	9/16	3/8 - 24
FJX-04-04	1/4	2.36	1.10	9/16	9/16	7/16 - 20
FJX-04-05	1/4	2.50	1.25	9/16	5/8	1/2 - 20
FJX-04-06	1/4	2.45	1.19	9/16	11/16	9/16 - 18
FJX-04-08	1/4	2.63	1.37	3/4	7/8	3/4 - 16
FJX-06-04	3/8	2.62	1.12	11/16	9/16	7/16 - 20
FJX-06-05	3/8	2.76	1.26	3/4	5/8	1/2 - 20
FJX-06-06	3/8	2.70	1.36	11/16	11/16	9/16 - 18
FJX-06-08	3/8	2.86	1.36	11/16	7/8	3/4 - 16
FJX-06-10	3/8	3.01	1.52	7/8	1	7/8 - 14
FJX-06-12	3/8	3.09	1.59	1	1-1/4	1-1/16 - 12
FJX-08-06	1/2	2.94	1.43	7/8	11/16	9/16 - 18
FJX-08-08	1/2	2.85	1.59	7/8	7/8	3/4 - 16
FJX-08-10	1/2	3.09	1.59	7/8	1	7/8 - 14
FJX-08-12	1/2	3.19	1.69	1-1/8	1-1/4	1-1/16 - 12
FJX-08-16	1/2	3.22	1.72	1-1/4	1-1/2	1-5/16 - 12
FJX-10-06	5/8	2.90	1.40	1-1/16	11/16	9/16 - 18
FJX-10-08	5/8	3.11	1.61	1-1/8	7/8	3/4 - 16
FJX-10-10	5/8	3.17	1.67	1-1/8	1	7/8 - 14
FJX-10-12	5/8	3.19	1.65	1-1/8	1-1/4	1-1/16 - 12
FJX-10-16	5/8	3.19	1.69	1-1/4	1-1/2	1-5/16 - 12
FJX-12-08	3/4	3.20	1.61	1-1/8	7/8	3/4 - 16
FJX-12-10	3/4	3.26	1.67	1-1/8	1	7/8 - 14
FJX-12-12	3/4	3.25	1.70	1-1/8	1-1/4	1-1/16 - 12
FJX-12-14	3/4	3.35	1.76	1-1/4	1-1/2	1-3/16 - 12
FJX-12-16	3/4	3.23	1.67	1-3/8	1-1/2	1-5/16 - 12
FJX-16-12	1	3.41	1.72	1-3/8	1-1/4	1-1/16 - 12
FJX-16-14	1	3.59	1.86	1-3/8	1-1/2	1-3/16 - 12
FJX-16-16	1	3.39	1.66	1-3/8	1-1/2	1-5/16 - 12
FJX-16-20	1	3.70	1.97	1-11/16	2	1-5/8 - 12
FJX-20-16	1-1/4	3.75	1.75	1-3/4	1-1/2	1-5/16 - 12
FJX-20-20	1-1/4	3.89	1.89	1-3/4	2	1-5/8 - 12

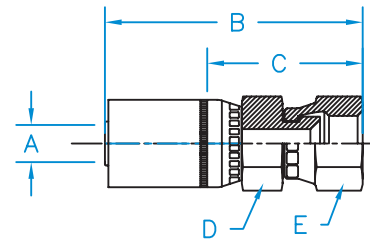

FJX45 - 37° JIC Female 45° Bent Tube Swivel

Part Number	Hose I.D. (in.) A	B	C	D	E	F	Thread
FJX45-04-04	1/4	3.14	1.88	5/8	0.39	9/16	7/16 - 20
FJX45-04-05	1/4	3.17	1.91	5/8	0.39	5/8	1/2 - 20
FJX45-04-06	1/4	3.21	1.96	5/8	0.43	11/16	9/16 - 18
FJX45-06-04	3/8	2.82	1.32	3/4	0.47	9/16	7/16 - 20
FJX45-06-05	3/8	3.43	1.93	11/16	0.39	5/8	1/2 - 20
FJX45-06-06	3/8	3.47	1.97	11/16	0.43	11/16	9/16 - 18
FJX45-06-08	3/8	3.81	2.31	3/4	0.59	7/8	3/4 - 16
FJX45-08-06	1/2	3.55	2.05	7/8	0.43	11/16	9/16 - 18
FJX45-08-08	1/2	3.91	2.41	7/8	0.59	7/8	3/4 - 16
FJX45-08-10	1/2	3.56	2.06	7/8	0.63	1	7/8 - 14
FJX45-10-10	5/8	3.81	2.31	1-1/8	0.63	1	7/8 - 14
FJX45-10-12	5/8	3.58	2.08	1-1/8	0.72	1-1/4	1-1/16 - 12
FJX45-12-12	3/4	3.94	2.34	1-1/8	0.83	1-1/4	1-1/16 - 12
FJX45-12-16	3/4	4.80	3.20	1-3/8	1.29	1-1/2	1-5/16 - 12
FJX45-16-12	1	4.90	3.16	1-3/8	1.15	1-1/4	1-1/16 - 12
FJX45-16-16	1	4.91	3.17	1-3/8	1.38	1-1/2	1-5/16 - 12
FJX45-16-20	1	5.07	3.33	1-3/8	1.41	2	1-5/8 - 12
FJX45-20-20	1-1/4	5.97	3.97	1-3/4	1.47	2	1-5/8 - 12

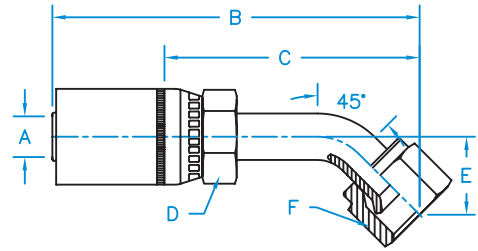

FJX90 - 37° JIC Female 90° Bent Tube Swivel

Part Number	Hose I.D. (in.) A	B	C	D	E	F	Thread
FJX90-04-04	1/4	2.98	1.72	5/8	0.83	9/16	7/16 - 20
FJX90-04-05	1/4	3.07	1.81	5/8	0.83	5/8	1/2 - 20
FJX90-04-06	1/4	3.12	1.87	5/8	0.91	11/16	9/16 - 18
FJX90-06-04	3/8	2.58	1.08	3/4	0.88	9/16	7/16 - 20
FJX90-06-05	3/8	3.33	1.83	11/16	0.83	5/8	1/2 - 20
FJX90-06-06	3/8	3.38	1.88	11/16	0.91	11/16	9/16 - 18
FJX90-06-08	3/8	3.63	2.13	3/4	1.12	7/8	3/4 - 16
FJX90-08-06	1/2	3.49	1.99	7/8	0.91	11/16	9/16 - 18
FJX90-08-08	1/2	3.75	2.25	7/8	1.13	7/8	3/4 - 16
FJX90-08-10	1/2	3.25	1.75	7/8	1.23	1	7/8 - 14
FJX90-08-12	1/2	3.78	2.28	1-1/8	1.83	1-1/4	1-1/16 - 12
FJX90-10-10	5/8	3.27	1.77	1-1/8	1.23	1	7/8 - 14
FJX90-10-12	5/8	3.67	2.17	1-1/8	1.92	1-1/4	1-1/16 - 12
FJX90-12-10	3/4	3.48	1.89	1-1/8	1.23	1	7/8 - 14
FJX90-12-12	3/4	3.89	2.30	1-1/8	1.83	1-1/4	1-1/16 - 12
FJX90-12-16	3/4	4.34	2.75	1-3/8	2.80	1-1/2	1-5/16 - 12
FJX90-16-16	1	4.50	2.77	1-3/8	2.80	1-1/2	1-5/16 - 12
FJX90-20-20	1-1/4	5.66	3.66	1-3/4	3.24	2	1-5/8 - 12

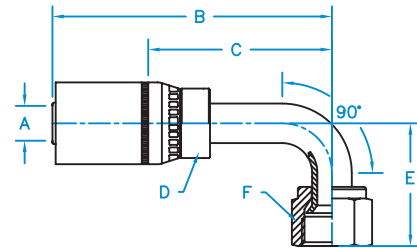

FJX90B - 37° JIC Female 90° Swivel Block Style

Part Number	Hose I.D. (in.) A	B	C	D	E	F	Thread
FJX90B-04-04	1/4	2.31	0.65	5/8	0.62	9/16	7/16 - 20
FJX90B-06-06	3/8	2.77	0.74	13/16	1.15	11/16	9/16 - 18
FJX90B-06-08	3/8	2.77	0.74	13/16	1.18	7/8	3/4 - 16
FJX90B-08-08	1/2	2.91	0.88	15/16	1.27	7/8	3/4 - 16
FJX90B-08-10	1/2	2.91	0.88	15/16	1.40	1	7/8 - 14
FJX90B-10-10	5/8	3.81	1.56	1-1/8	1.54	1	7/8 - 14
FJX90B-12-10	3/4	3.45	1.11	1-1/4	1.57	1	7/8 - 14
FJX90B-12-12	3/4	3.45	1.11	1-1/4	1.60	1-1/4	1-1/16 - 12
FJX90B-12-16	3/4	3.45	1.11	1-1/4	1.67	1-1/2	1-5/16 - 12

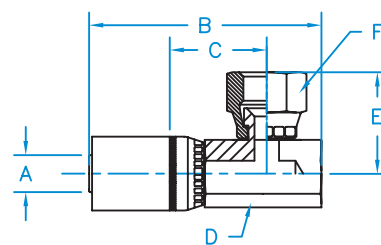

FJX90L - 37° JIC Female 90° Long Drop Swivel

Part Number	Hose I.D. (in.) A	B	C	D	E	F	Thread
FJX90L-04-04	1/4	2.98	1.72	5/8	1.81	9/16	7/16 - 20
FJX90L-04-05	1/4	3.07	1.81	5/8	1.77	5/8	1/2 - 20
FJX90L-04-06	1/4	3.12	1.87	5/8	2.13	11/16	9/16 - 18
FJX90L-06-04	3/8	2.58	1.08	3/4	1.80	9/16	7/16 - 20
FJX90L-06-06	3/8	3.38	1.88	11/16	2.13	11/16	9/16 - 18
FJX90L-06-08	3/8	3.68	2.18	3/4	2.52	7/8	3/4 - 16
FJX90L-08-08	1/2	3.75	2.25	7/8	2.52	7/8	3/4 - 16
FJX90L-08-10	1/2	3.50	2.00	7/8	2.76	1	7/8 - 14
FJX90L-10-10	5/8	3.73	2.23	1-1/16	2.65	1	7/8 - 14
FJX90L-10-12	5/8	3.67	2.17	1-1/8	3.80	1-1/4	1-1/16 - 12
FJX90L-12-12	3/4	3.89	2.30	1-3/8	3.78	1-1/2	1-1/16 - 12
FJX90L-16-16	1	4.67	2.94	1-3/8	4.30	1-1/2	1-5/16 - 12

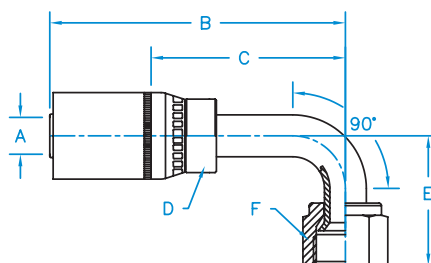

FJX90M - 37° JIC Female 90° Bent Tube Swivel Medium Drop

Part Number	Hose I.D. (in.) A	B	C	D	E	F	Thread
FJX90M-04-04	1/4	2.98	1.72	5/8	1.26	9/16	7/16 - 20
FJX90M-06-06	3/8	3.38	1.88	3/4	1.50	11/16	9/16 - 18
FJX90M-08-08	1/2	3.75	2.25	7/8	1.61	7/8	3/4 - 16
FJX90M-08-10	1/2	3.41	1.91	7/8	1.85	1	7/8 - 14
FJX90M-10-10	5/8	3.43	1.93	1-1/8	1.85	1	7/8 - 14
FJX90M-12-12	3/4	3.89	2.30	1-1/8	2.28	1-1/4	1-1/16 - 12

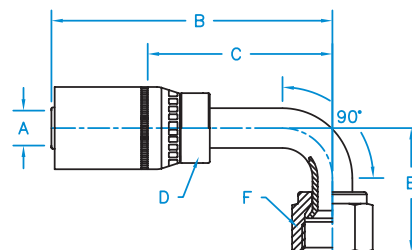

FJXT - 37° JIC Female Swivel Long

Part Number	Hose I.D. (in.) A	B	C	D	E	Thread
FJXT-04-04	1/4	2.98	1.72	5/8	9/16	7/16 - 20
FJXT-04-05	1/4	2.98	1.72	5/8	5/8	1/2 - 20
FJXT-06-05	3/8	3.20	1.70	11/16	5/8	1/2 - 20
FJXT-06-06	3/8	3.76	2.25	11/16	11/16	9/16 - 18
FJXT-06-08	3/8	3.89	2.39	3/4	7/8	3/4 - 16
FJXT-08-08	1/2	3.96	2.46	7/8	7/8	3/4 - 16
FJXT-08-10	1/2	4.22	2.72	7/8	1	7/8 - 14

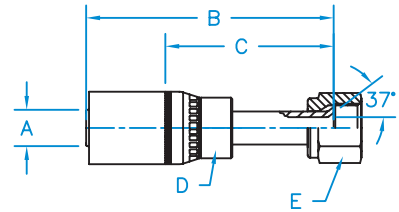

FP - NPTF Female Pipe Rigid

Part Number	Hose I.D. (in.) A	B	C	D	Thread
FP-04-02	1/4	2.34	1.09	5/8	1/8 - 27
FP-04-04	1/4	2.34	1.09	11/16	1/4 - 18
FP-04-06	1/4	2.44	1.18	7/8	3/8 - 18
FP-06-04	3/8	2.70	1.20	11/16	1/4 - 18
FP-06-06	3/8	2.70	1.20	7/8	3/8 - 18
FP-06-08	3/8	2.86	1.36	1	1/2 - 14
FP-08-08	1/2	2.93	1.44	1	1/2 - 14
FP-12-08	3/4	3.11	1.52	1-1/4	1/2 - 14
FP-12-12	3/4	3.14	1.55	1-1/4	3/4 - 14
FP-16-16	1	3.49	1.75	1-1/2	1 - 11-1/2

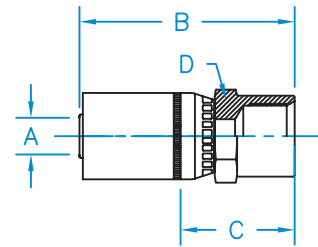

FPX - Female Pipe NPSM Swivel

Part Number	Hose I.D. (in.) A	B	C	D	E	Thread
FPX-03-04	3/16	2.16	1.10	5/8	3/4	1/4 - 18
FPX-04-02	1/4	2.94	1.04	9/16	9/16	1/8 - 27
FPX-04-04	1/4	2.15	1.09	9/16	3/4	1/4 - 18
FPX-06-06	3/8	2.34	1.09	11/16	3/4	3/8 - 18
FPX-06-08	3/8	2.85	1.35	7/8	1	1/2 - 14
FPX-08-06	1/2	2.81	1.31	7/8	7/8	3/8 - 18
FPX-08-08	1/2	2.70	1.43	11/16	7/8	1/2 - 14
FPX-08-12	1/2	3.20	1.70	1	1-1/4	3/4 - 14
FPX-12-12	3/4	2.93	1.70	1	1	3/4 - 14
FPX-16-16	1	3.29	1.78	1-1/8	1-1/4	1 - 11-1/2
FPX-20-20	1-1/4	4.02	2.02	1-3/4	2	1-1/4 - 11-1/2

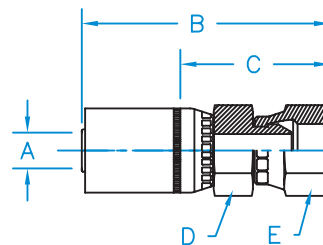

FSX - 45° SAE Female Swivel

Part Number	Hose I.D. (in.) A	B	C	D	E	Thread
FSX-04-06	1/4	2.60	1.34	11/16	3/4	5/8 - 18
FSX-06-06	3/8	2.86	1.36	11/16	3/4	5/8 - 18
FSX-12-12	3/4	3.25	1.66	1-1/8	1-1/4	1-1/16 - 14

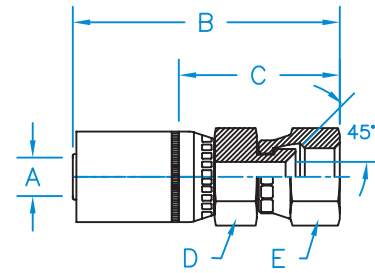

FSX45 - 45° SAE Female 45° Bent Tube Swivel

Part Number	Hose I.D. (in.) A	B	C	D	E	F	Thread
FSX45-04-04	1/4	3.14	1.88	5/8	0.39	9/16	7/16 - 20
FSX45-04-05	1/4	3.17	1.91	5/8	0.39	5/8	1/2 - 20
FSX45-06-05	3/8	3.43	1.93	11/16	0.39	5/8	1/2 - 20
FSX45-06-06	3/8	3.47	1.97	11/16	0.43	3/4	5/8 - 18
FSX45-08-08	1/2	3.91	2.41	7/8	0.59	15/16	3/4 - 16
FSX45-08-10	1/2	3.56	2.06	7/8	0.63	1-1/16	7/8 - 14
FSX45-10-12	5/8	3.78	2.28	1-1/8	0.92	1-1/4	1-1/16 - 14
FSX45-12-12	3/4	3.88	2.28	1-1/8	0.83	1-1/4	1-1/16 - 14

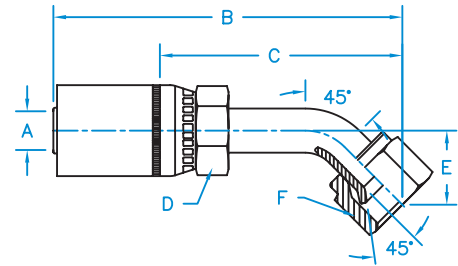

FSX90 - 45° SAE Female 90° Bent Tube Swivel

Part Number	Hose I.D. (in.) A	B	C	D	E	F	Thread
FSX90-04-04	1/4	2.98	1.72	5/8	0.83	9/16	7/16 - 20
FSX90-04-05	1/4	3.07	1.81	5/8	0.87	5/8	1/2 - 20
FSX90-06-04	3/8	3.24	1.74	11/16	0.83	9/16	7/16 - 20
FSX90-06-05	3/8	3.33	1.83	11/16	0.87	5/8	1/2 - 20
FSX90-06-06	3/8	3.38	1.88	11/16	0.91	3/4	5/8 - 18
FSX90-06-08	3/8	3.68	2.18	3/4	1.13	15/16	3/4 - 16
FSX90-08-08	1/2	3.75	2.25	7/8	1.13	15/16	3/4 - 16
FSX90-08-10	1/2	3.25	1.75	7/8	1.23	1-1/16	7/8 - 14
FSX90-10-12	5/8	3.72	2.22	1-1/8	1.83	1-1/4	1-1/16 - 14
FSX90-12-12	3/4	3.89	2.30	1-1/8	1.83	1-1/4	1-1/16 - 14

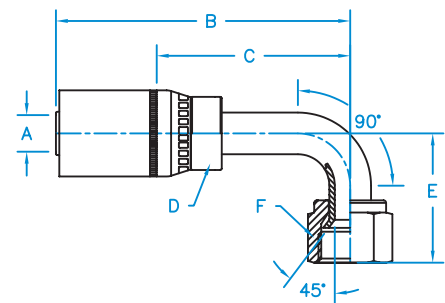

FSXT - 45° SAE Female Swivel

Part Number	Hose I.D. (in.) A	B	C	D	E	Thread
FSXT-04-04	1/4	3.04	1.79	5/8	9/16	7/16 - 20
FSXT-04-05	1/4	3.05	1.80	5/8	5/8	1/2 - 20
FSXT-06-04	3/8	3.30	1.80	11/16	9/16	7/16 - 20
FSXT-06-05	3/8	3.31	1.81	11/16	5/8	1/2 - 20
FSXT-06-06	3/8	3.85	2.35	11/16	3/4	5/8 - 18
FSXT-06-08	3/8	4.24	2.74	3/4	15/16	3/4 - 16
FSXT-08-08	1/2	4.09	2.59	7/8	15/16	3/4 - 16
FSXT-08-10	1/2	4.38	2.88	7/8	1	7/8 - 14

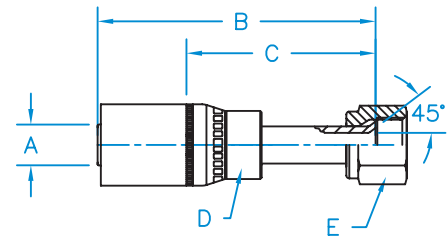

Hose Mender

Part Number	Hose I.D. (in.) A	B	C	D	Thread
MENDER 12	3/4	4.01	0.36	1-1/4	N/A
MENDER 16	1	4.32	0.38	1-1/2	N/A
MENDER 6	3/8	3.72	0.27	7/8	N/A
MENDER 8	1/2	3.88	0.34	1	N/A
MENDER 4	1/4	3.42	0.91	5/8	N/A

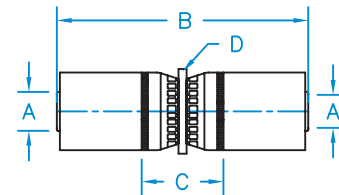

JIS 30° Female Swivel

Part Number	Hose I.D. (in.) A	B	C	D	E	Thread
F-JISX-04-04	1/4	2.58	1.22	9/16	3/4	1/4 - 19
F-JISX-06-06	3/8	2.83	1.33	11/16	7/8	3/8 - 19
F-JISX-08-08	1/2	3.12	1.62	7/8	1	1/2 - 14
F-JISX-10-10	5/8	3.24	1.74	1-1/8	1-1/4	5/8 - 14
F-JISX-12-12	3/4	3.32	1.74	1-1/8	1-1/4	3/4 - 14
F-JISX-16-16	1	3.46	1.72	1-3/8	1-1/2	1 - 11

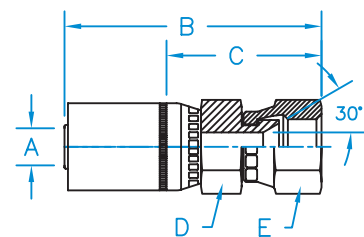

Komatsu Flange 45° Bent Tube Rigid

Part Number	Hose I.D. (in.) A	B	C	E	Thread
KOMA45-08-10	1/2	3.81	2.31	0.88	N/A
KOMA45-10-10	5/8	3.83	2.33	0.88	N/A

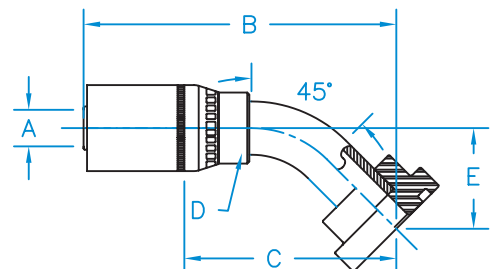

Komatsu Flange 90° Bent Tube Rigid

Part Number	Hose I.D. (in.) A	B	C	E	Thread
KOMA90-08-10	1/2	3.71	2.21	1.91	N/A
KOMA90-10-10	5/8	3.73	2.23	1.91	N/A

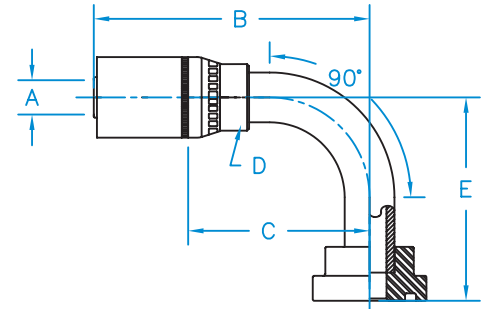

Komatsu JIS 30° Seat Female Swivel

Part Number	Hose I.D. (in.) A	B	C	D	E	Thread
F-KOMX-04-14	1/4	2.55	1.29	9/16	11/16	M14 X 1.5
F-KOMX-06-18	3/8	2.73	1.23	11/16	7/8	M18 X 1.5
F-KOMX-08-22	1/2	3.13	1.62	7/8	1-1/16	M22 X 1.5
F-KOMX-08-24	1/2	3.34	1.84	7/8	1-1/4	M24 X 1.5
F-KOMX-10-24	5/8	3.04	1.54	1-1/8	1-1/4	M24 X 1.5
F-KOMX-12-30	3/4	3.47	1.88	1-1/8	1-1/2	M30 X 1.5
F-KOMX-16-33	1	3.82	2.08	1-3/8	1-5/8	M33 X 1.5

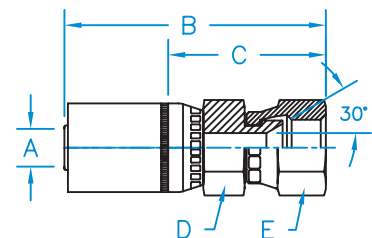

Komatsu JIS 30° Seat 45° Bent Tube Female Swivel

Part Number	Hose I.D. (in.) A	B	C	D	E	F	Thread
F-KOMX45-04-14	1/4	3.58	2.33	5/8	0.80	11/16	M14 X 1.5
F-KOMX45-06-18	3/8	3.84	2.34	11/16	0.80	7/8	M18 X 1.5
F-KOMX45-08-22	1/2	3.85	2.35	7/8	0.94	1-1/16	M22 X 1.5
F-KOMX45-10-24	5/8	4.14	2.64	1-1/8	1.04	1-1/4	M24 X 1.5
F-KOMX45-12-30	3/4	4.40	2.80	1-1/8	1.17	1-1/2	M30 X 1.5
F-KOMX45-16-33	1	5.03	3.30	1-3/8	1.29	1-5/8	M33 X 1.5

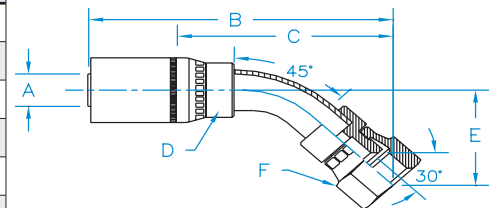

Komatsu JIS 30° Seat 90° Bent Tube Female Swivel

Part Number	Hose I.D. (in.) A	B	C	D	E	F	Thread
F-KOMX90-04-14	1/4	3.12	1.87	5/8	1.48	11/16	M14 X 1.5
F-KOMX90-06-18	3/8	3.38	1.88	11/16	1.52	7/8	M18 X 1.5
F-KOMX90-08-22	1/2	3.75	2.25	7/8	1.72	1-1/16	M22 X 1.5
F-KOMX90-10-24	5/8	3.27	1.77	1-1/8	2.25	1-1/4	M24 X 1.5
F-KOMX90-12-30	3/4	3.95	2.35	1-1/8	2.45	1-1/2	M30 X 1.5
F-KOMX90-16-33	1	4.56	2.83	1-3/8	2.79	1-5/8	M33 X 1.5

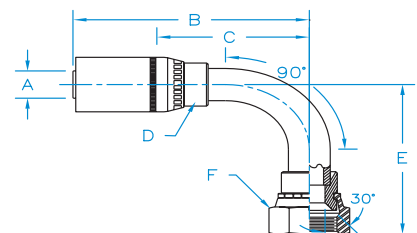

LF - Line Fit Sleeveless Design

Part Number	Hose I.D. (in.) A	B	C	D	E	Thread
LF-04-04	1/4	2.40	1.15	9/16	9/16	7/16 - 20
LF-04-05	1/4	2.40	1.15	5/8	5/8	1/2 - 20
LF-04-06	1/4	2.49	1.23	9/16	11/16	9/16 - 18
LF-04-08	1/4	2.55	1.30	7/8	7/8	3/4 - 16
LF-06-05	3/8	2.63	1.13	3/4	5/8	1/2 - 20
LF-06-06	3/8	2.73	1.23	11/16	11/16	9/16 - 18
LF-06-08	3/8	2.81	1.31	7/8	7/8	3/4 - 16
LF-06-10	3/8	2.74	1.24	7/8	1	7/8 - 14
LF-08-08	1/2	2.88	1.38	7/8	7/8	3/4 - 16
LF-08-10	1/2	2.82	1.32	7/8	1	7/8 - 14
LF-08-12	1/2	3.16	1.66	1	1-1/4	1-1/16 - 12
LF-12-12	3/4	3.27	1.68	1-1/4	1-1/4	1-1/16 - 12

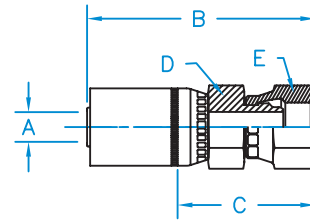

Male British Parallel Pipe 60° Cone Rigid

Part Number	Hose I.D. (in.) A	B	C	D	Thread
M-BSPP-04-04	1/4	2.40	1.15	13/16	1/4 - 19
M-BSPP-04-06	1/4	2.46	1.20	7/8	3/8 - 19
M-BSPP-06-06	3/8	2.72	1.22	7/8	3/8 - 19
M-BSPP-06-08	3/8	2.83	1.33	1-1/16	1/2 - 14
M-BSPP-08-06	1/2	2.80	1.30	7/8	3/8 - 19
M-BSPP-08-08	1/2	2.92	1.42	1-1/16	1/2 - 14
M-BSPP-10-10	5/8	3.03	1.53	1-1/4	5/8 - 14
M-BSPP-10-12	5/8	2.99	1.15	11/16	3/4 - 14
M-BSPP-12-12	3/4	3.08	1.49	1-3/8	3/4 - 14
M-BSPP-16-16	1	3.41	1.67	1-5/8	1 - 11

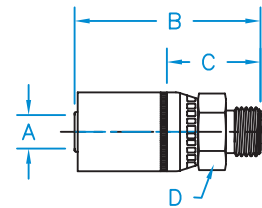

Male British Standard Pipe 60° Cone Rigid

Part Number	Hose I.D. (in.) A	B	C	D	Thread
M-BSPT-04-02	1/4	2.13	0.88	9/16	1/8 - 27
M-BSPT-04-04	1/4	2.32	1.06	11/16	1/4 - 19
M-BSPT-04-06	1/4	2.40	1.15	11/16	3/8 - 19
M-BSPT-06-06	3/8	2.67	1.50	3/4	3/8 - 19
M-BSPT-06-08	3/8	2.92	1.42	7/8	1/2 - 14
M-BSPT-08-06	1/2	2.74	1.24	7/8	3/8 - 19
M-BSPT-08-08	1/2	3.00	1.51	7/8	1/2 - 14
M-BSPT-12-12	3/4	3.10	1.51	1-1/8	3/4 - 14
M-BSPT-16-16	1	3.45	1.72	1-3/8	1 - 11

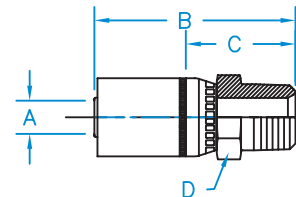

Male Boss O-Ring Rigid

Part Number	Hose I.D. (in.) A	B	C	D	Thread
MB-03-04	3/16	1.92	0.86	9/16	7/16 - 20
MB-04-04	1/4	2.11	0.86	5/8	7/16 - 20
MB-04-05	1/4	2.11	0.86	5/8	1/2 - 20
MB-04-06	1/4	2.15	0.89	11/16	9/16 - 18
MB-04-08	1/4	2.34	1.09	7/8	3/4 - 16
MB-06-06	3/8	2.50	1.00	11/16	9/16 - 18
MB-06-08	3/8	2.54	1.04	13/16	3/4 - 16
MB-06-10	3/8	2.65	1.15	1-1/16	7/8 - 14
MB-08-08	1/2	2.68	1.18	1-1/8	3/4 - 16
MB-08-10	1/2	2.75	1.25	1	7/8 - 14
MB-08-12	1/2	2.84	1.34	1-1/4	1-1/16 - 12
MB-10-10	5/8	2.76	1.26	1-1/4	7/8 - 14
MB-10-12	5/8	2.86	1.36	1-1/4	1-1/16 - 12
MB-12-10	3/4	2.75	1.25	1-1/4	7/8 - 14
MB-12-12	3/4	2.95	1.36	1-1/4	1-1/16 - 12
MB-12-14	3/4	2.95	1.36	1-1/2	1-3/16 - 12
MB-12-16	3/4	3.05	1.46	1-1/2	1-5/16 - 12
MB-16-12	1	3.11	1.37	1-1/2	1-1/16 - 12
MB-16-16	1	3.21	1.48	1-1/2	1-5/16 - 12

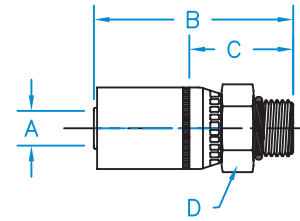

MBX - Male Boss O-Ring Swivel

Part Number	Hose I.D. (in.) A	B	C	D	E	Thread
MBX-04-04	1/4	2.75	1.50	9/16	11/16	7/16 - 20
MBX-04-05	1/4	2.78	1.52	9/16	3/4	1/2 - 20
MBX-04-06	1/4	2.79	1.53	9/16	3/4	9/16 - 18
MBX-06-04	3/8	3.07	1.57	11/16	11/16	7/16 - 20
MBX-06-06	3/8	3.11	1.64	11/16	3/4	9/16 - 18
MBX-06-08	3/8	3.18	1.62	11/16	15/16	3/4 - 16
MBX-06-10	3/8	3.27	1.77	11/16	1	7/8 - 14
MBX-08-08	1/2	3.28	2.03	7/8	15/16	3/4 - 16
MBX-08-10	1/2	3.49	1.85	7/8	1	7/8 - 14
MBX-12-10	3/4	3.82	2.23	1-1/8	1	3/8 - 18
MBX-12-12	3/4	3.92	2.34	1-1/8	1-1/8	1-1/16 - 12
MBX-16-16	1	3.98	2.25	1-3/8	1-1/2	1-5/16 - 12

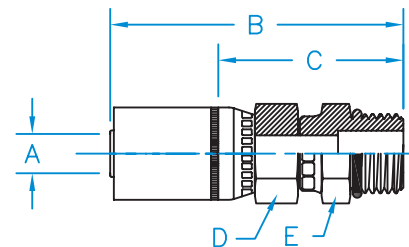

MBX90 - Male Boss O-Ring 90° Swivel Block Style

Part Number	Hose I.D. (in.) A	B	C	D	E	Thread
MBX90-04-04	1/4	2.31	0.65	11/16	1.41	7/16 - 20
MBX90-04-06	1/4	2.31	0.65	3/4	1.45	9/16 - 18
MBX90-06-06	3/8	2.77	0.74	3/4	1.54	9/16 - 18
MBX90-06-08	3/8	2.77	0.74	15/16	1.61	3/4 - 16
MBX90-06-10	3/8	2.77	0.74	1	1.61	7/8 - 14
MBX90-08-08	1/2	2.91	0.88	15/16	1.68	3/4 - 16
MBX90-08-10	1/2	2.91	0.88	1	1.74	7/8 - 14
MBX90-10-10	5/8	3.81	1.56	1	1.88	7/8 - 14
MBX90-12-12	3/4	3.63	1.00	1-1/8	2.36	1-1/16 - 12

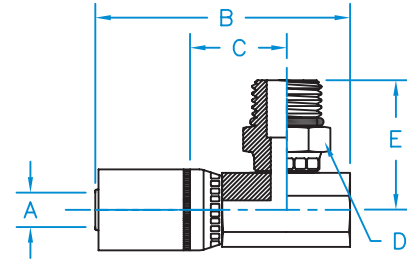

Metric O.D. Stand Pipe 45° Bent Tube

Part Number	Hose I.D. (in.) A	B	C	D	E	F	Thread
MMSP45-04-06	1/4	3.40	2.06	5/8	0.66	6MM	N/A
MMSP45-04-08	1/4	3.54	2.19	5/8	0.75	8MM	N/A
MMSP45-04-10	1/4	3.68	2.31	5/8	0.84	10MM	N/A
MMSP45-06-10	3/8	3.69	2.34	3/4	0.84	10MM	N/A
MMSP45-06-12	3/8	3.93	2.56	3/4	0.90	12MM	N/A
MMSP45-06-14	3/8	4.07	2.72	7/8	0.99	14MM	N/A
MMSP45-08-15	1/2	4.18	2.81	7/8	0.96	15MM	N/A
MMSP45-08-16	1/2	4.35	2.00	7/8	1.11	16MM	N/A
MMSP45-08-18	1/2	4.54	2.94	1	1.01	18MM	N/A
MMSP45-10-18	5/8	4.31	2.94	1-1/8	1.01	18MM	N/A
MMSP45-10-20	5/8	4.58	3.19	1-1/8	1.24	20MM	N/A
MMSP45-12-20	3/4	4.58	3.19	1-1/8	1.24	20MM	N/A
MMSP45-12-22	3/4	4.57	3.00	1-1/4	1.08	22MM	N/A
MMSP45-12-25	3/4	4.96	3.38	1-3/8	1.38	25MM	N/A
MMSP45-16-25	1	5.42	3.38	1-3/8	1.38	25MM	N/A
MMSP45-16-28	1	5.22	3.59	1-3/8	1.18	28MM	N/A
MMSP45-16-30	1	5.61	4.00	1-1/2	1.52	30MM	N/A

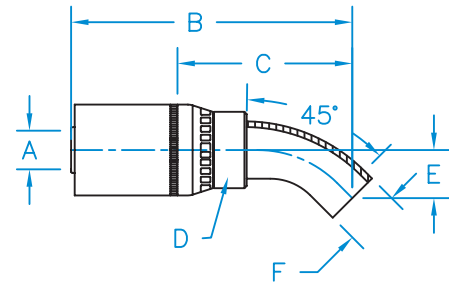

Metric O.D. Stand Pipe 90° Bent Tube

Part Number	Hose I.D. (in.) A	B	C	D	E	F	Thread
MMSP90-04-06	1/4	2.95	1.59	5/8	1.14	6MM	N/A
MMSP90-04-08	1/4	3.07	1.72	5/8	1.34	8MM	N/A
MMSP90-04-10	1/4	3.18	1.84	5/8	1.54	10MM	N/A
MMSP90-06-10	3/8	3.20	1.83	3/4	1.54	10MM	N/A
MMSP90-06-12	3/8	3.44	2.09	3/4	1.69	12MM	N/A
MMSP90-06-14	3/8	3.56	2.22	7/8	1.89	14MM	N/A
MMSP90-08-15	1/2	3.75	2.41	7/8	1.89	15MM	N/A
MMSP90-08-16	1/2	3.79	2.44	7/8	2.13	16MM	N/A
MMSP90-08-18	1/2	3.72	2.53	1	2.05	18MM	N/A
MMSP90-10-18	5/8	3.92	2.53	1-1/8	2.05	18MM	N/A
MMSP90-10-20	5/8	4.04	2.66	1-1/8	2.44	20MM	N/A
MMSP90-12-20	3/4	4.04	2.66	1-1/8	2.44	20MM	N/A
MMSP90-12-22	3/4	4.25	2.69	1-1/4	2.28	22MM	N/A
MMSP90-12-25	3/4	4.45	2.88	1-3/8	2.84	25MM	N/A
MMSP90-16-25	1	4.91	2.88	1-3/8	2.84	25MM	N/A
MMSP90-16-28	1	5.01	3.41	1-3/8	2.64	28MM	N/A
MMSP90-16-30	1	5.13	3.50	1-1/2	3.19	30MM	N/A

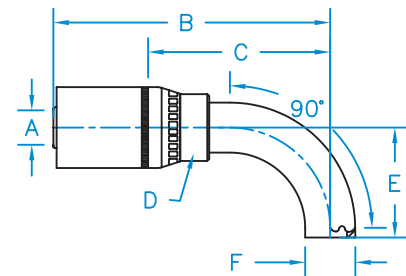

Metric O.D. Stand Tube Rigid

Part Number	Hose I.D. (in.) A	B	C	D	E	Thread
MMSP-04-06	1/4	3.01	1.66	5/8	6MM	N/A
MMSP-04-08	1/4	3.09	1.72	5/8	8MM	N/A
MMSP-04-10	1/4	3.16	1.81	5/8	10MM	N/A
MMSP-06-10	3/8	3.18	1.81	3/4	10MM	N/A
MMSP-06-12	3/8	3.22	1.80	3/4	12MM	N/A
MMSP-06-14	3/8	3.30	1.94	7/8	14MM	N/A
MMSP-08-15	1/2	3.33	1.97	7/8	15MM	N/A
MMSP-08-16	1/2	3.53	2.16	7/8	16MM	N/A
MMSP-08-18	1/2	3.33	1.97	1	18MM	N/A
MMSP-10-18	5/8	3.34	1.97	1-1/8	18MM	N/A
MMSP-10-20	5/8	3.62	2.22	1-1/8	20MM	N/A
MMSP-12-20	3/4	3.75	2.12	1-1/8	20MM	N/A
MMSP-12-22	3/4	3.40	1.88	1-1/4	22MM	N/A
MMSP-12-25	3/4	3.79	2.22	1-3/8	25MM	N/A
MMSP-16-25	1	4.06	2.44	1-3/8	25MM	N/A
MMSP-16-28	1	3.72	2.09	1-3/8	28MM	N/A
MMSP-16-30	1	4.15	2.53	1-1/2	30MM	N/A

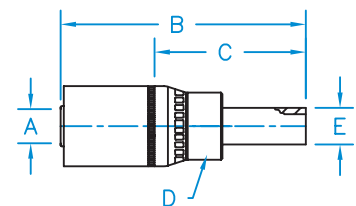

MF - Male O-Ring Face Seal Rigid

Part Number	Hose I.D. (in.) A	B	C	D	Thread
MF-04-04	1/4	2.34	1.07	5/8	9/16 - 18
MF-04-06	1/4	2.19	0.94	11/16	11/16-16
MF-06-06	3/8	2.45	0.95	11/16	11/16 - 16
MF-06-08	3/8	2.52	1.02	7/8	13/16 - 16
MF-08-08	1/2	2.59	1.09	7/8	13/16 - 16
MF-08-10	1/2	2.86	1.36	1-1/16	1 - 14
MF-08-12	1/2	2.92	1.42	1-1/4	1-3/16 - 12
MF-10-10	5/8	2.87	1.37	1-1/8	1 - 14
MF-10-12	5/8	2.93	1.43	1-1/4	1-3/16 - 12
MF-12-12	3/4	3.02	1.43	1-1/4	1-3/16 - 12
MF-12-16	3/4	3.04	1.45	1-1/2	1-7/16 - 12
MF-16-12	1	3.18	1.45	1-3/8	1-3/16 - 12
MF-16-16	1	3.20	1.47	1-1/2	1-7/16 - 12

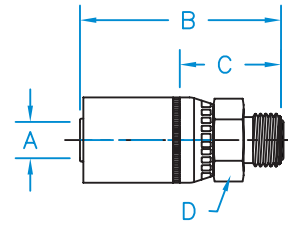

MIX - 45° SAE Male Inverted Flare

Part Number	Hose I.D. (in.) A	B	C	D	E	Thread
MIX-04-03	1/4	3.01	1.75	9/16	3/8	3/8 - 24
MIX-04-04	1/4	3.20	1.96	5/8	7/16	7/16 - 24
MIX-04-05	1/4	3.26	2.00	5/8	1/2	1/2 - 20
MIX-04-06	1/4	2.90	1.65	5/8	5/8	5/8 - 18
MIX-06-04	3/8	3.48	1.98	11/16	7/16	7/16 - 24
MIX-06-05	3/8	3.17	1.81	3/4	1/2	1/2 - 20
MIX-06-06	3/8	3.16	2.32	3/4	5/8	5/8 - 18
MIX-06-07	3/8	3.16	1.67	3/4	11/16	11/16 - 18
MIX-06-08	3/8	3.42	1.92	3/4	3/4	3/4 - 18
MIX-08-08	1/2	3.81	2.31	7/8	3/4	3/4 - 18
MIX-08-10	1/2	3.46	1.96	7/8	3/4	7/8 - 18

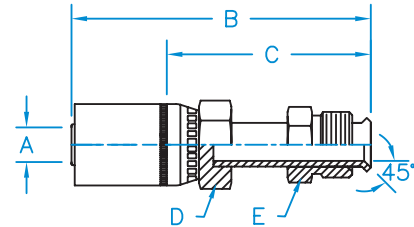

MIX45 - 45° SAE Male Inverted Flare 45° Bent Tube Swivel

Part Number	Hose I.D. (in.) A	B	C	D	E	F	Thread
MIX45-04-03	1/4	2.94	1.69	9/16	0.72	3/8	3/8 - 24
MIX45-04-04	1/4	2.96	1.70	5/8	0.78	7/16	7/16 - 24
MIX45-04-05	1/4	3.09	1.84	5/8	0.88	1/2	1/2 - 20
MIX45-04-06	1/4	3.72	2.47	5/8	0.94	5/8	5/8 - 18
MIX45-06-05	3/8	3.34	1.84	3/4	0.88	1/2	1/2 - 20
MIX45-06-06	3/8	3.98	2.48	3/4	0.94	5/8	5/8 - 18
MIX45-06-07	3/8	3.98	2.48	3/4	0.94	11/16	11/16 - 18
MIX45-06-08	3/8	4.31	2.81	3/4	1.06	3/4	3/4 - 18
MIX45-08-08	1/2	4.38	2.88	7/8	1.06	3/4	3/4 - 18
MIX45-08-10	1/2	3.93	2.43	7/8	0.84	7/8	7/8 - 18

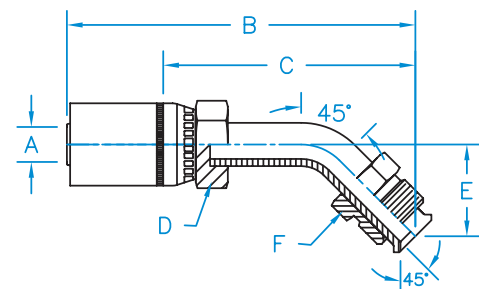

MIX90 - 45° SAE Male Inverted Flare 90° Bent Tube Swivel

Part Number	Hose I.D. (in.) A	B	C	D	E	F	Thread
MIX90-03-04	3/16	1.94	1.00	7/16	1.47	7/16	7/16 - 24
MIX90-04-03	1/4	3.02	1.76	9/16	1.38	3/8	3/8 - 24
MIX90-04-04	1/4	2.37	1.11	5/8	1.47	7/16	7/16 - 24
MIX90-04-05	1/4	2.54	1.28	5/8	1.66	1/2	1/2 - 20
MIX90-04-06	1/4	3.93	2.68	5/8	1.69	5/8	5/8 - 18
MIX90-06-04	3/8	2.63	1.13	11/16	1.47	7/16	7/16 - 24
MIX90-06-05	3/8	2.69	1.19	3/4	1.82	1/2	1/2 - 20
MIX90-06-06	3/8	4.19	2.69	3/4	1.69	5/8	5/8 - 18
MIX90-06-07	3/8	4.19	2.69	3/4	1.69	11/16	11/16 - 18
MIX90-06-08	3/8	3.68	2.18	3/4	1.88	3/4	3/4 - 18
MIX90-08-08	1/2	3.75	2.25	7/8	1.88	3/4	3/4 - 18
MIX90-08-10	1/2	3.03	1.53	7/8	1.63	7/8	7/8 - 18

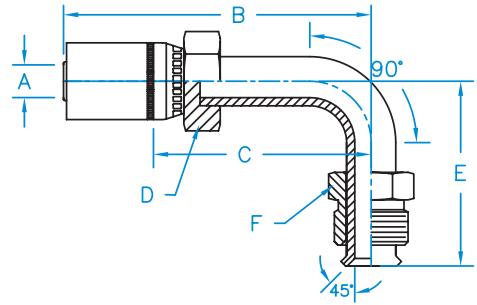

MJ - 37° JIC Male Rigid

Part Number	Hose I.D. (in.) A	B	C	D	Thread
MJ-04-04	1/4	2.30	1.05	9/16	7/16 - 20
MJ-04-05	1/4	2.31	1.05	9/16	1/2 - 20
MJ-04-06	1/4	2.31	1.06	9/16	9/16 - 18
MJ-06-04	3/8	2.66	1.16	11/16	7/16 - 20
MJ-06-05	3/8	2.60	1.10	3/4	1/2 - 20
MJ-06-06	3/8	2.66	1.17	11/16	9/16 - 18
MJ-06-08	3/8	2.76	1.27	3/4	3/4 - 16
MJ-06-10	3/8	2.94	1.44	7/8	7/8 - 14
MJ-08-06	1/2	2.74	1.24	7/8	9/16 - 18
MJ-08-08	1/2	2.85	1.35	7/8	3/4 - 16
MJ-08-10	1/2	3.00	1.51	7/8	7/8 - 14
MJ-08-12	1/2	3.11	1.61	1-1/8	1-1/16 - 12
MJ-10-08	5/8	2.87	1.37	1-1/16	3/4 - 16
MJ-10-10	5/8	3.02	1.52	1-1/8	7/8 - 14
MJ-10-12	5/8	3.13	1.63	1-1/8	1-1/16 - 12
MJ-12-10	3/4	3.06	1.47	1-1/8	7/8 - 14
MJ-12-12	3/4	3.22	1.63	1-1/8	1-1/16 - 12
MJ-12-14	3/4	3.24	1.65	1-1/4	1-3/16 - 12
MJ-12-16	3/4	3.27	1.67	1-3/8	1-5/16 - 12
MJ-16-14	1	3.4	1.67	1-3/8	1-3/16 - 12
MJ-16-16	1	3.42	1.69	1-3/8	1-5/16 - 12
MJ-20-20	1-1/4	3.85	1.85	1-3/4	1-5/8 - 12

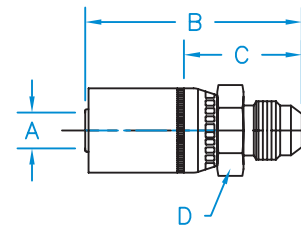

MP - Male Pipe NPTF Rigid

Part Number	Hose I.D. (in.) A	B	C	D	Thread
MP-02-02	1/8	1.30	0.74	1/2	1/8 - 27
MP-03-02	3/16	1.93	0.87	9/16	1/8 - 27
MP-04-02	1/4	2.13	0.88	9/16	1/8 - 27
MP-04-04	1/4	2.32	1.06	9/16	1/4 - 18
MP-04-06	1/4	2.41	1.15	11/16	3/8 - 18
MP-04-08	1/4	2.66	1.40	7/8	1/2 - 14
MP-06-04	3/8	2.67	1.17	11/16	1/4 - 18
MP-06-06	3/8	2.67	1.17	11/16	3/8 - 18
MP-06-08	3/8	2.92	1.42	7/8	1/2 - 14
MP-08-04	1/2	2.81	1.31	7/8	1/4 - 18
MP-08-06	1/2	2.74	1.25	7/8	3/8 - 18
MP-08-08	1/2	3.00	1.50	7/8	1/2 - 14
MP-08-12	1/2	3.00	1.50	1-1/8	3/4 - 14
MP-10-08	5/8	3.01	1.51	1-1/8	1/2 - 14
MP-10-12	5/8	3.01	1.51	1-1/8	3/4 - 14
MP-12-08	3/4	3.10	1.51	1-1/8	1/2 - 14
MP-12-12	3/4	3.10	1.51	1-1/8	3/4 - 14
MP-12-16	3/4	3.29	1.70	1-3/8	1 - 11-1/2
MP-16-12	1	3.26	1.53	1-1/8	3/4 - 14
MP-16-16	1	3.45	1.72	1-3/8	1 - 11-1/2
MP-16-16-API	1	4.59	2.85	1-3/8	1 - 11-1/2
MP-20-20	1-1/4	3.80	1.80	1-3/4	1-1/4 - 11-1/2

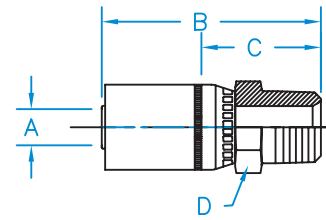

MPX - Male Pipe NPTF Swivel

Part Number	Hose I.D. (in.) A	B	C	D	E	Thread
MPX-04-02	1/4	2.59	1.34	9/16	1/2	1/8 - 27
MPX-04-04	1/4	2.88	1.62	9/16	11/16	1/4 - 18
MPX-04-06	1/4	2.88	1.63	9/16	3/4	3/8 - 18
MPX-06-04	3/8	3.20	1.67	11/16	11/16	1/4 - 18
MPX-06-06	3/8	3.20	1.71	11/16	3/4	3/8 - 18
MPX-06-08	3/8	3.40	1.90	11/16	7/8	1/2 - 14
MPX-08-06	1/2	3.31	1.81	7/8	3/4	3/8 - 18
MPX-08-08	1/2	3.53	2.04	7/8	15/16	1/2 - 14
MPX-08-12	1/2	3.61	2.11	1	1-1/8	3/4 - 14
MPX-10-08	5/8	3.64	2.14	1-1/16	15/16	1/2 - 14
MPX-10-12	5/8	3.69	2.19	1-1/16	1-1/8	3/4 - 14
MPX-12-08	3/4	3.83	2.24	1-1/8	15/16	1/2 - 14
MPX-12-12	3/4	3.70	2.10	1-1/8	1-1/8	3/4 - 14
MPX-16-16	1	4.12	2.38	1-3/8	1-1/2	1 - 11-1/2

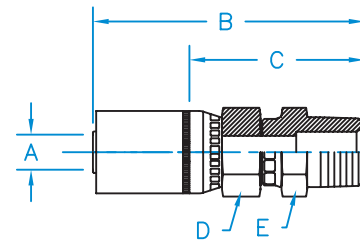

MPX90 - Male Pipe 90° Swivel Block Style

Part Number	Hose I.D. (in.) A	B	C	D	E	Thread
MPX90-04-04	1/4	2.31	0.65	11/16	1.54	1/4 - 18
MPX90-04-06	1/4	2.31	0.65	3/4	1.54	3/8 - 18
MPX90-06-04	3/8	2.77	0.74	11/16	1.54	1/4 - 18
MPX90-06-06	3/8	2.77	0.74	3/4	1.64	3/8 - 18
MPX90-06-08	3/8	2.77	0.74	7/8	1.84	1/2 - 14
MPX90-08-06	1/2	2.91	0.88	3/4	1.07	3/8 - 18
MPX90-08-08	1/2	2.91	0.88	15/16	1.92	1/2 - 14
MPX90-12-12	3/4	3.63	1.00	1-1/8	2.14	3/4 - 14
MPX90-16-16	1	3.86	1.25	1-1/2	2.58	1 - 11-1/2

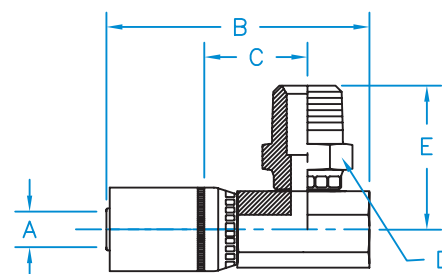

MS - 45° SAE Male Rigid

Part Number	Hose I.D. (in.) A	B	C	D	Thread
MS-04-04	1/4	2.30	1.05	9/16	7/16 - 20
MS-04-06	1/4	2.52	1.27	11/16	5/8 - 18
MS-06-06	3/8	2.73	1.23	3/4	5/8 - 18
MS-06-08	3/8	2.76	1.26	3/4	3/4 - 16
MS-08-08	1/2	2.85	1.35	7/8	3/4 - 16
MS-12-12	3/4	3.35	1.76	1-1/8	1-1/16 - 14

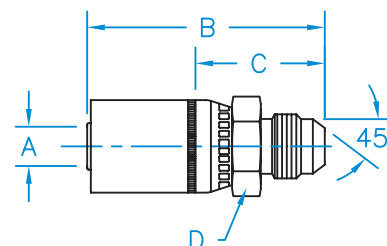

MT - Flareless Compression with Nut and Sleeve Per SAE J514

Part Number	Hose I.D. (in.) A	B	C	D	Thread
MT-04-04	1/4	2.18	0.92	9/16	7/16 - 20
MT-04-05	1/4	2.18	0.92	5/8	1/2 - 20
MT-04-06	1/4	2.19	0.94	3/4	9/16 - 18
MT-04-08	1/4	2.32	1.06	7/8	3/4 - 16
MT-06-04	3/8	2.44	0.94	3/4	7/16 - 20
MT-06-05	3/8	2.53	1.03	3/4	1/2 - 20
MT-06-06	3/8	2.44	0.96	3/4	9/16 - 18
MT-06-08	3/8	2.58	1.08	3/4	3/4 - 16
MT-08-08	1/2	2.66	1.16	7/8	3/4 - 16
MT-08-10	1/2	2.72	1.22	7/8	7/8 - 14
MT-08-12	1/2	2.84	1.34	1-1/4	1-1/16 - 12
MT-12-12	3/4	2.95	1.36	1-1/4	1-1/16 - 12
MT-12-16	3/4	3.03	1.44	1-1/2	1-5/16 - 12
MT-16-16	1	3.18	1.45	1-1/2	1-5/16 - 12

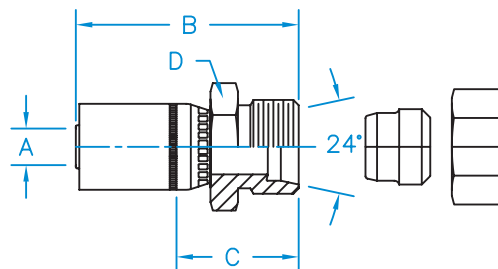

MW - Stand Tube Rigid

Part Number	Hose I.D. (in.) A	B	C	D	E	Thread
MW-04-04	1/4	2.72	1.47	5/8	1/4	N/A
MW-04-05	1/4	2.83	1.58	5/8	5/16	N/A
MW-04-06	1/4	2.91	1.66	5/8	3/8	N/A
MW-06-06	3/8	3.16	1.67	3/4	3/8	N/A
MW-06-08	3/8	3.42	1.92	3/4	1/2	N/A
MW-08-08	1/2	3.61	2.04	7/8	1/2	N/A
MW-08-10	1/2	3.82	2.13	7/8	5/8	N/A
MW-12-12	3/4	4.86	2.98	1-1/8	3/4	N/A
MW-16-16	1	4.79	3.05	1-3/8	1	N/A

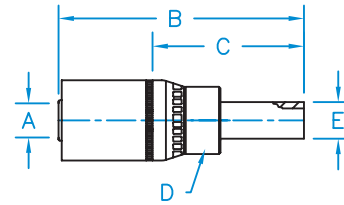

SHELL - Shell Only

Part Number	A	B	Hose I.D. (in.)	Thread
SHELL-10	1-1/4	2.06	5/8	N/A
SHELL-12	1-3/8	2.03	3/4	N/A
SHELL-16	1-11/16	2.57	1	N/A
SHELL-4	3/4	1.50	1/4	N/A
SHELL-6	0.9	1.68	3/8	N/A
SHELL-8	1-1/16	1.87	1/2	N/A

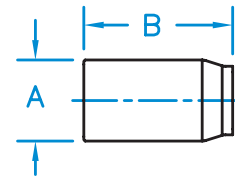

FW - Female Weld Fitting Rigid

Part Number	Hose I.D. (in.) A	B	C	D	E	Thread
FW-03-04	3/16	1.68	0.45	9/16	1/4	N/A
FW-04-04	1/4	1.88	0.63	5/8	1/4	N/A
FW-04-05	1/4	1.88	0.63	5/8	5/16	N/A
FW-04-06	1/4	1.88	0.63	5/8	3/8	N/A
FW-06-06	3/8	2.14	0.64	11/16	3/8	N/A
FW-06-08	3/8	2.14	0.64	3/4	1/2	N/A
FW-08-08	1/2	2.21	0.71	7/8	1/2	N/A
FW-08-10	1/2	2.21	0.71	7/8	5/8	N/A
FW-10-10	5/8	2.23	0.73	1-1/8	5/8	N/A
FW-12-12	3/4	2.48	0.86	1-1/8	3/4	N/A
FW-16-16	1	2.61	0.87	1-3/8	1	N/A
FW-16-20	1	2.73	1.00	1-5/8	1-1/4	N/A
FW-20-20	1-1/4	2.89	0.89	1-3/4	1-1/4	N/A

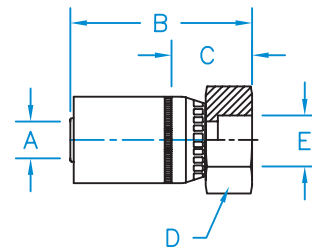

Karcher Pressure Wash Female Swivel

Part Number	Hose I.D. (in.) A	B	C	D	Thread
KAR-04-22	1/4	2.52	1.26	3/4	M22 X 1.5
KAR-06-22	3/8	2.78	1.26	3/4	M22 X 1.5

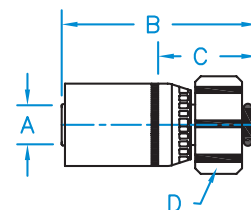



KURT

HYDRAULICS

www.kurthydraulics.com

Other Kurt Divisions

kurt.com

kurtworkholding.com

kurtdiecasting.com

kurtmachining.com

Kurt Hydraulics 114 West O Street, Lyman, NE 69352
www.kurthydraulics.com | Toll Free: 866.257.7995 | hydraulicsales@kurt.com